



**SUBJECT:** MOONEY ULTRA INTERIOR DOOR HANDLE UPGRADE

**MODELS/ SN AFFECTED:** M20U OVATION ULTRA 32-0002 thru 32-0005  
M20V ACCLAIM ULTRA 33-0002, 33-0003, 33-0005

**TIME OF COMPLIANCE:** AS REQUIRED

**INTRODUCTION:** Mooney International Corporation has developed a new door handle design. This Service Instruction has been written in 2 Steps, for convenience. **Step 1:** How to remove and replace existing door handle with the new design. **Step 2:** Sending the door panels to the factory for repair and recover.

**INSTRUCTIONS:** Read entire procedures before beginning work.

### **STEP 1 - Install New Bellcrank and Handle Assembly**

- 1.1. On Pilot and Co-Pilot side entrance doors, cover wing walk area with protective cover.
- 1.2. Open Pilot and Co-Pilot doors, remove interior door handle placard screws, and remove placard as shown in Figure SIM20-130-1.
- 1.3. Remove door handle pull screws and remove upper and lower interior door panel screws, keep for reassembly, remove panels from door as shown in Figure SIM20-130-1.
- 1.4. Remove cabin door handle cover plate, with (3) screws and (3) washers, and 1 outer bushing (plastic), keep for re-assembly.
- 1.5. Locate and remove 3 clevis attachment points to bellcrank, cotter pins and washers, keep clevis pins 1 and 2 and washers for reassembly. Clevis pin #3 will require a new one found in the kit.
- 1.6. Install new bushing LFI-0405-08 into bellcrank and install into door. Due to tight clearance, it may be helpful to temporarily install clevis pin #3 into bellcrank hole and temporarily secure with a cotter pin before installing into position. Install #1 and #2 clevis pins, washers and new cotter pins. On # 3 clevis, carefully pull temporary cotter pin out, slide clevis pin out far enough to install clevis, push #3 clevis pin thru and add washer, secure with new cotter pin. See figure SIM20-130-2.
- 1.7. Re-install cabin door handle cover plate and 1 bushing onto bellcrank shaft, and secure with (3) screws and (3) washers, from dis-assembly.
- 1.8. Before installing interior door panels, check adjustment of the latching mechanism. Make any necessary adjustments per the service and maintenance manual.
- 1.9. If sending interior door panels for re-upholstery at this time, Refer to **Step 2**.
- 1.10. If not sending interior door panels at this time, temporary install lower interior door panels, and mark where the cutout should be for bellcrank shaft to protrude thru panel.
- 1.11. Carefully cutout a hole thru panel for bellcrank arm to protrude, see figure SIM20-130-2.
- 1.12. Install Upper and Lower interior door panels, use loctite 222MS on screws and secure panels as shown in Figure SIM20-130-1.
- 1.13. Slide new door handle 310389-1 onto bellcrank shaft, add loctite 222 (Purple) or 242 (Blue) to screw threads MS24694-C15 and secure door handle.
- 1.14. Install new placards SIM20-130-003 LH and SIM20-130-004 RH on existing metal door handle placard and mount back into position with existing screws to cover slot.
- 1.15. Add Placard p/n 150110-A1048B (LH) or 150110-A1049B (RH) to upper door panel.
- 1.16. Add Storm Window Stops: (This limits travel of storm window in the open position)
  - a. Remove lower hinge screws, see Figure SIM20-130-2.



- b. Add 320021-13 Stops to both lower hinges.
- c. Secure with (2) new screws MS24693-S25 (use existing nut).
- 1.17. Return aircraft to service.
- 1.18. Procedure complete.

**STEP 2 - Send Interior Panel in to Mooney:**

- 2.1. Temporary install lower interior door panels, carefully cutout hole for bellcrank shaft to protrude thru panel, check fitment (hole centered) before sending to Mooney.
- 2.2. Call Mooney Service Parts 830.792.2901 for RMA and schedule repair - Allow approximately 1 week to recover panels and send back to you.
- 2.3. Package and Send both top and bottom panels to Mooney International Corporation "Attention Mooney Service Parts" to: 165 Al Mooney Road North, Kerrville, Texas 78028
- 2.4. Once door panels are returned from Mooney, test fit door panels, and install 130400-65 Trim Ring with RAS13270 adhesive in center of hole cutout. Install Upper and Lower interior door panels, use loctite 222MS on screws and secure panels as shown in Figure SIM20-130-1.
- 2.5. Slide new door handle 310389-1 onto bellcrank shaft, add loctite 222 (Purple) or 242 (Blue) to screw threads and secure.
- 2.6. Return aircraft to service.
- 2.7. Procedure complete.

**NOTE:**

**Fill out compliance card and send by MAIL, FAX or EMAIL to Mooney International Corporation as indicated on the attached Compliance Card (Refer to Figure SIM20-130-4).**

**WARRANTY:** Mooney International Corporation will warrant labor 2.5 hours when work is completed in accordance with **STEP 1** procedures and 2 hours when work is completed in accordance with **STEP 2** procedures of this Service Instruction for aircraft currently covered under the Mooney International Corporation factory warranty program.

**REFERENCE DATA:** 1. Applicable Mooney International Service and Maintenance Manual

**PARTS LIST: Service Instruction Kit SIM20-130-001**

<u>Item</u>	<u>P/N</u>	<u>Description</u>	<u>Qty</u>
1.	310389- 1	Handle, Door (LH/RH)	2
2.	MS24694-C15	Screw	2
3.	310388- 1	Bellcrank (LH)	1
4.	310388- 2	Bellcrank (RH)	1
5.	LFI-0408-08	Bushing (install into LH/RH Bellcranks)	2
6.	MS20392-2C15	Clevis Pins	2
7.	NAS1149F0332P	Washers	3
8.	MS24665-151	Cotter Pins	3
9.	150110- A1048B	Placard, Door Handle (LH)	1
10.	150110- A1049B	Placard, Door Handle (RH)	1
11.	SIM20-130-003	Placard, Cover Door Slot (LH)	1
12.	SIM20-130-004	Placard, Cover Door Slot (RH)	1
13.	130400- 65	Trim Ring, Door Panel	2
14.	320021- 13	Stop, Pilot Window	2
15.	MS24693- S25	Screws	2
	Shop Supplied	Loctite® 222MS	AR
	Shop Supplied	Adhesive RAS13270	AR

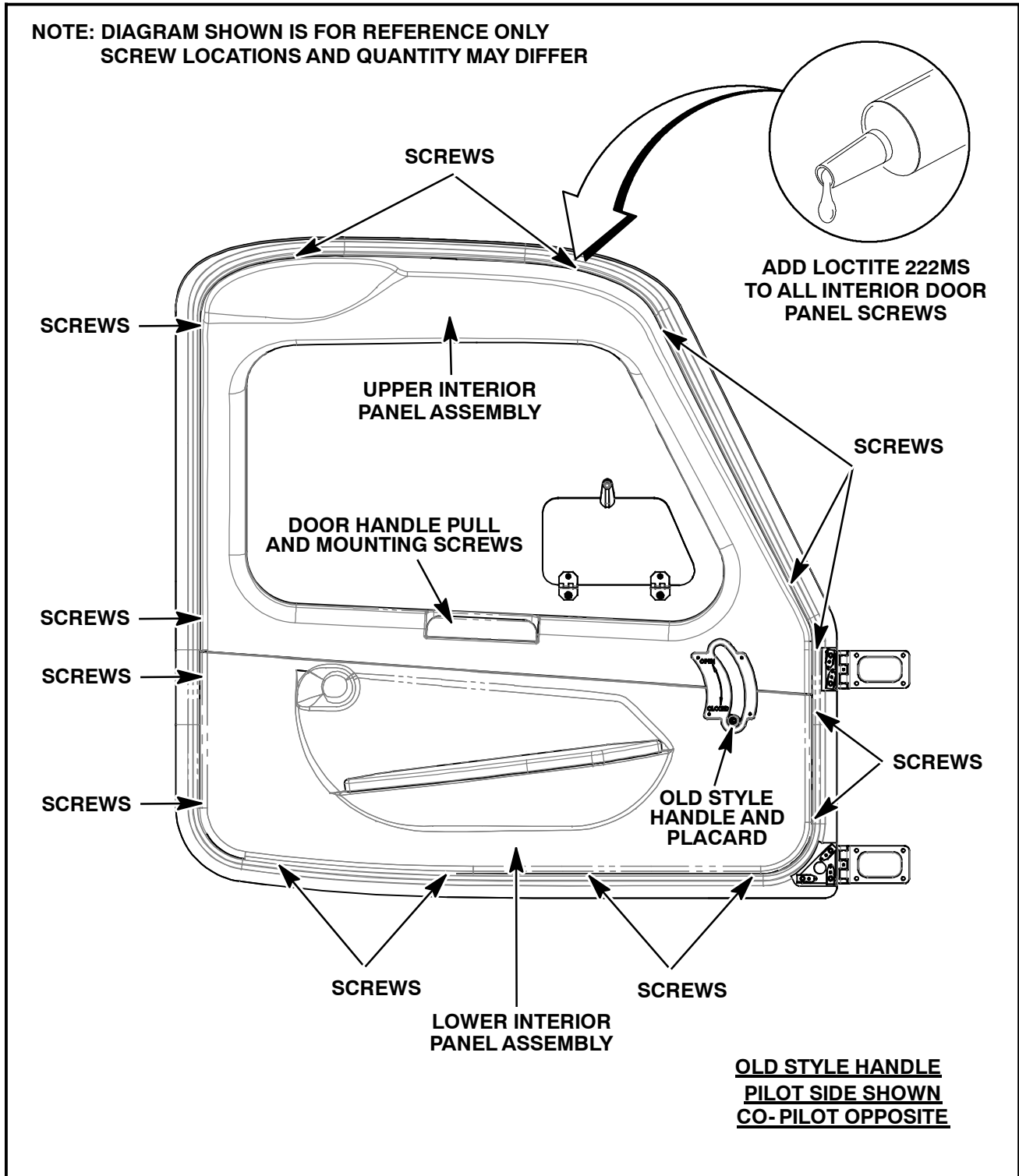
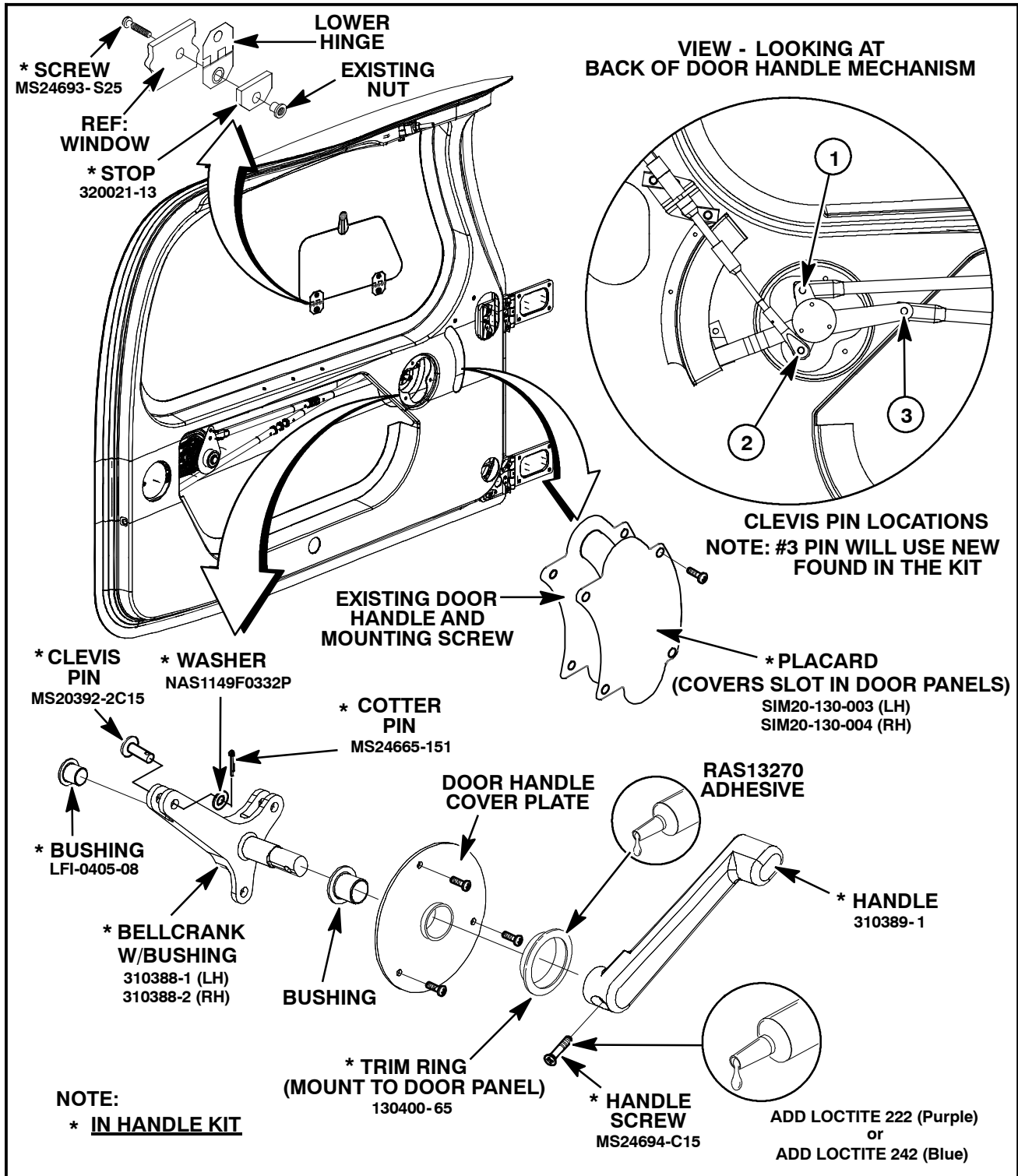

Figure SIM20-130-1 - EXISTING INTERIOR DOOR PANEL AND HANDLE ASSEMBLY



165 Al Mooney Road North  
Kerrville, Texas 78028

**SERVICE INSTRUCTION SIM20-130**  
Date: SEPTEMBER 20, 2018



**Figure SIM20-130-2 - INTERIOR DOOR HANDLE MECHANISM AND STORM WINDOW**

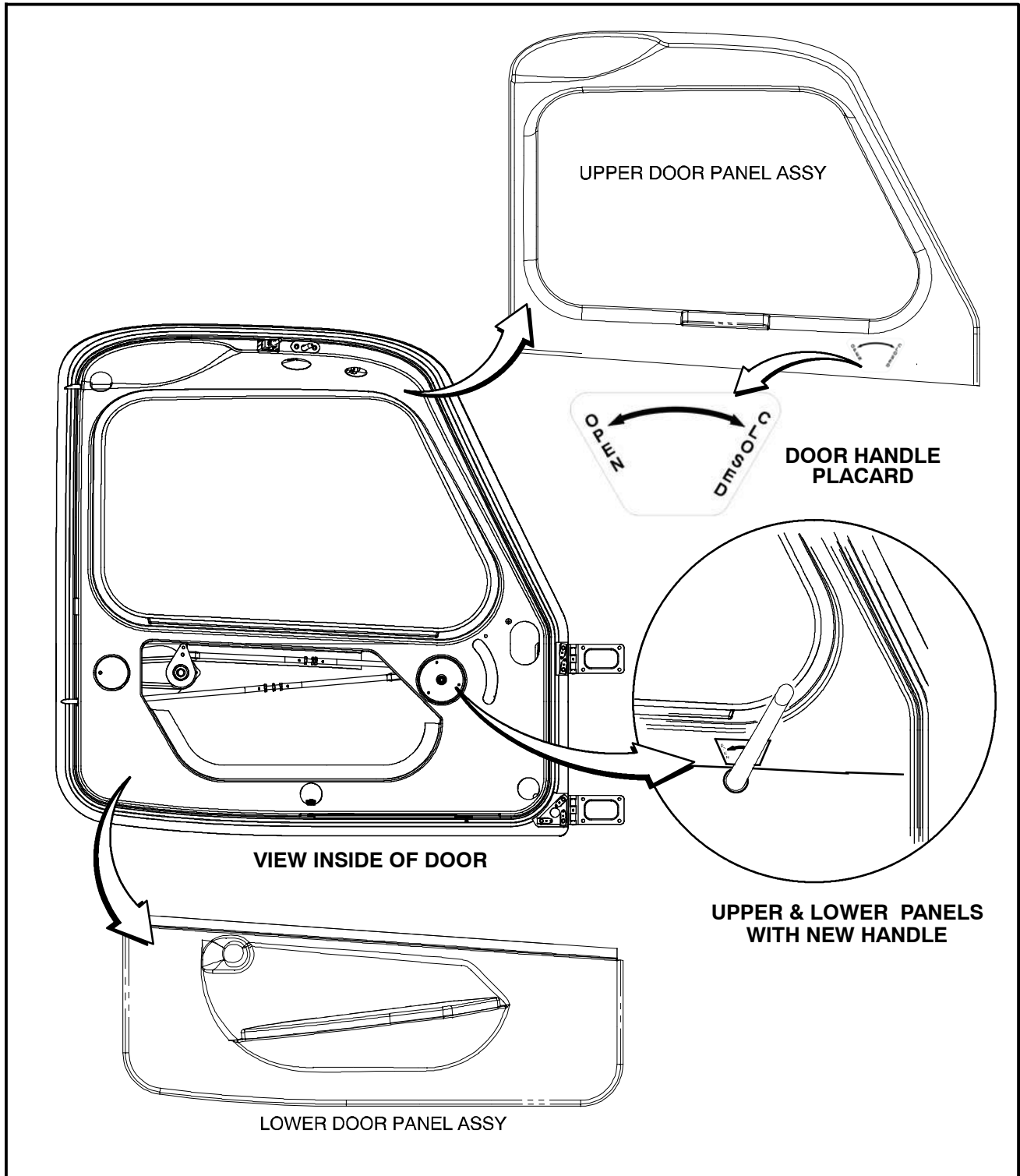

**Figure SIM20-130-3 - NEW INTERIOR DOOR PANELS**



**MOONEY INTERNATIONAL CORPORATION**  
KERRVILLE, TEXAS 78028 - FAX 830-257-4635

SERVICE (BULLETIN) (INSTRUCTION) NO. \_\_\_\_\_ HAS BEEN COMPLIED  
WITH ON AIRCRAFT MODEL \_\_\_\_\_ SERIAL NUMBER \_\_\_\_\_

Tach. Time: \_\_\_\_\_ N-Number \_\_\_\_\_ (Reg. No.)  
Owner: \_\_\_\_\_ Date of Compliance: \_\_\_\_\_  
\_\_\_\_\_ Complied  
By: \_\_\_\_\_

Inspection Report: \_\_\_\_\_  
\_\_\_\_\_  
\_\_\_\_\_

Form 07-0001

\_\_\_\_\_  
\_\_\_\_\_  
\_\_\_\_\_

PLACE  
STAMP  
HERE

**MOONEY INTERNATIONAL CORPORATION**  
ATT'N: TECHNICAL PUBLICATIONS DEPT  
165 Al Mooney Road, North  
Kerrville, Texas 78028

**SEND TO: Mooney International Corporation**  
165 Al Mooney Road North  
Kerrville, TX 78028  
FAX: (830) 257-4635 or EMAIL TO: [techpubs@mooney.com](mailto:techpubs@mooney.com)

**Figure SIM20-130-4 - FILL OUT COMPLIANCE CARD**